



**ARISTA**IPC

# Pharma Manufacturing Products Selection Guide

---

[www.aristaipc.com](http://www.aristaipc.com)



# »» Table of Contents

<b>Introduction</b>	<b>4</b>
<b>A Mobile Operator Workstations</b>	<b>6</b>
<b>B Operator Workstations</b>	<b>8</b>
<b>C Waterproof Panel PCs Series</b>	<b>11</b>
<b>D Waterproof Remote Display Series</b>	<b>13</b>
<b>Selection Guide</b>	<b>14</b>

## » Introduction



## Computing Platforms & KPI Visualization

---

ARISTA has developed a broad range of products for the pharmaceutical manufacturing process. Whether it is a batch or a continuous manufacturing process, such as API synthesis, crystallization, blending, granulation, tablet compression, or capsule coating. ARISTA has the automated process computing platforms or KPI visualization solutions for the cleanroom pharmaceutical manufacturing.

ARISTA computing and display solutions for the pharmaceutical industry are built with SS316L NEMA 4X/IP66 stainless steel enclosure to meet the highest hygiene requirements in pharmaceutical industries. Our broad and diverse solutions include Mobile Operator Workstation, Operator Workstation, Industrial Waterproof Panel PCs, and Industrial Remote Touch Displays.

The mobile workstations and operator workstation provide the options of waterproof membrane and rubber keyboards to cater to your individual needs. The mobile workstations have optional large capacity 1024A/h lithium battery to support multiple operational shifts; barcode scanners holder and space for label printers are also available depending on the model and configuration. The 55" wall recessed operator workstation is perfect for KPI visualization in cleanroom and let you master the full information from your production.



## Why ARISTA

Long product life cycle, revision control and flexible customization are the three major characteristics of ARISTA products and the reasons why pharmaceutical companies choose ARISTA as an essential partner among many manufacturers.

### Longevity

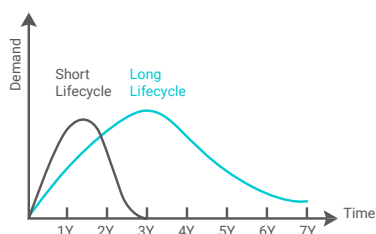

In the pharmaceutical industry, high reliability and stability are crucial. ARISTA's products guarantee a long product life cycle of 5-7 years, which allowing pharmaceutical manufactures not to worry about revalidating the replacement in critical manufacturing process.

### Revision Control

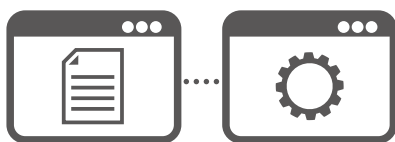

ARISTA also has a Revision Control mechanism. In the event of a product design modification or part replacement takes place, we will notify our customers about the product revision and let them decide whether to conduct a test for the new version.

### Flexible Customization

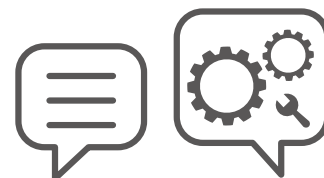

Our customers have high customization requirements, and ARISTA can provide small batch productions in varieties. We listen to the voices of customers and strive to meet their needs.



## A Mobile Operator Workstations High-capacity battery, wireless communication

ARISTA mobile workstations share a unique feature, that is having the interior room to hold a 1024Ah high capacity lithium battery, allowing you to work anywhere uninterruptedly. ARISTA mobile workstation models provide the Wi-Fi function, allow wireless communication in all corners of the laboratory, clean room, and factory. Also, there is a barcode scanner holder to the either side of the workstation to accommodate right or left-handed operation, which makes it convenient when you scan a barcode to verify or identify materials and other items. Some of our models even have space for a label printer. So you can scan the bar code and print out a label immediately. This design will improve your work efficiency.

The mobile workstations are integrated with projected capacitive touch and come in different sizes of LCD displays; we offer models in 18, 19, 21.5 and 24 inches LCD touch displays. There are three options for the single-display models: single screen, dual-screen (19 or 4 inch), and triple-screen configurations. You can choose one of the three industrial grade waterproof keyboards : the KB-115A-AX membrane keyboard, or the KB-115B-AX and the KB-115C-AX rubber keyboards. The main difference between the latter two rubber keyboards is the design of the mouse control. There are lighter and smaller footprint base options available if customer does not require battery for the mobile workstation.



Mobile



NEMA 4X



IP66



Wi-Fi



Touch panel resistive touch



Printer



Battery



Barcode scanner



ThinManager Ready



## Pharmaceutical Manufacturing Goes Mobile

### Going Wireless

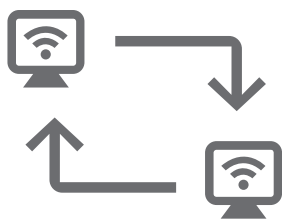

The system is powered by a compact heavy-duty battery that allows the mobile workstation to function seamlessly and uninterrupted while in motion. It is fully functional without the need for hard-wired access to power and communication sources. ARISTA wireless workstations save time from connection management and significantly increase workplace productivity.

### Mobility

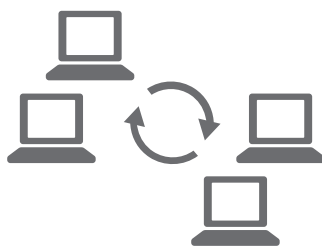

When it comes to large support systems like workstations, the ability to move the tool from one place to another maximizes its utility and reduces equipment redundancy. In addition, using mobile workstations enables rapid and easy reorganization of the work environment and process flow for more flexible management.

### Customization



As individual pharmaceutical facilities often have unique requirements, the ARISTA Industrial Mobile Operator Workstations can be customized to meet client needs. Depending upon the level of change needed, the process can range anywhere from six to eight weeks for minor customization, or up to several months for more extensive projects.



There are various mounting methods for AMA-AX Series.

And this series of workstation comes with 3 optional keyboards to provide users with the best of ergonomics.

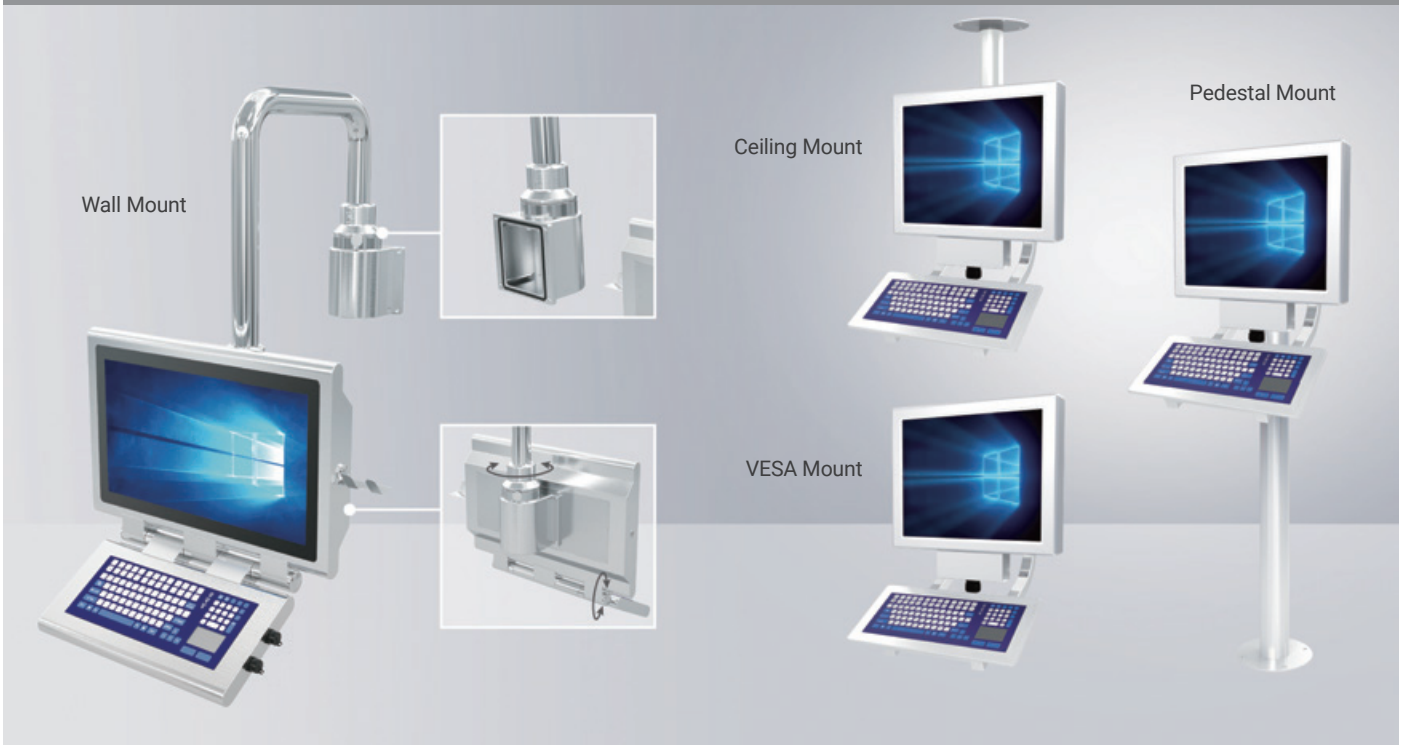

# B

## Operator Workstations

### Ergonomic & flexible use of limited space

ARISTA Operator Workstations provide diverse installation mounting options according to the different needs of customers, including benchtop, wall mount, wall-recessed, ceiling mount, VESA mount, and pedestal mount types. We also offer a highly flexible stainless steel pendant arm design for space saving utilization. The 360° double-joint(single-screen) and triple-joint (dual-screen) designs make the wall flush installation, folding, and retracting of the workstation easy tasks, and they are great for installations in the hallway or to make the best use of limited space.

The angle of the screen or keyboard in some models can be adjusted to complement the needs of operators' various heights and provide the most comfortable ergonomic way to operate the workstation for an extended period. When installing workstation in the hallway area, the wall-recessed workstations is the perfect solution. The fanless cooling design is implemented in all of our wall-recessed models to ensure the workstations operate stably and reliably. Besides the 15, 17, 19 and 21.5-inch displays, we also offer the 4K 55-inch large-format display workstation for you to use it as a Quad View display so you can visualize your KPIs and take full control of your production data.



NEMA 4X



IP66



Touch panel resistive touch



Touch panel projected capacitive touch



Quad view



Wall recessed



Fanless



ThinManager Ready



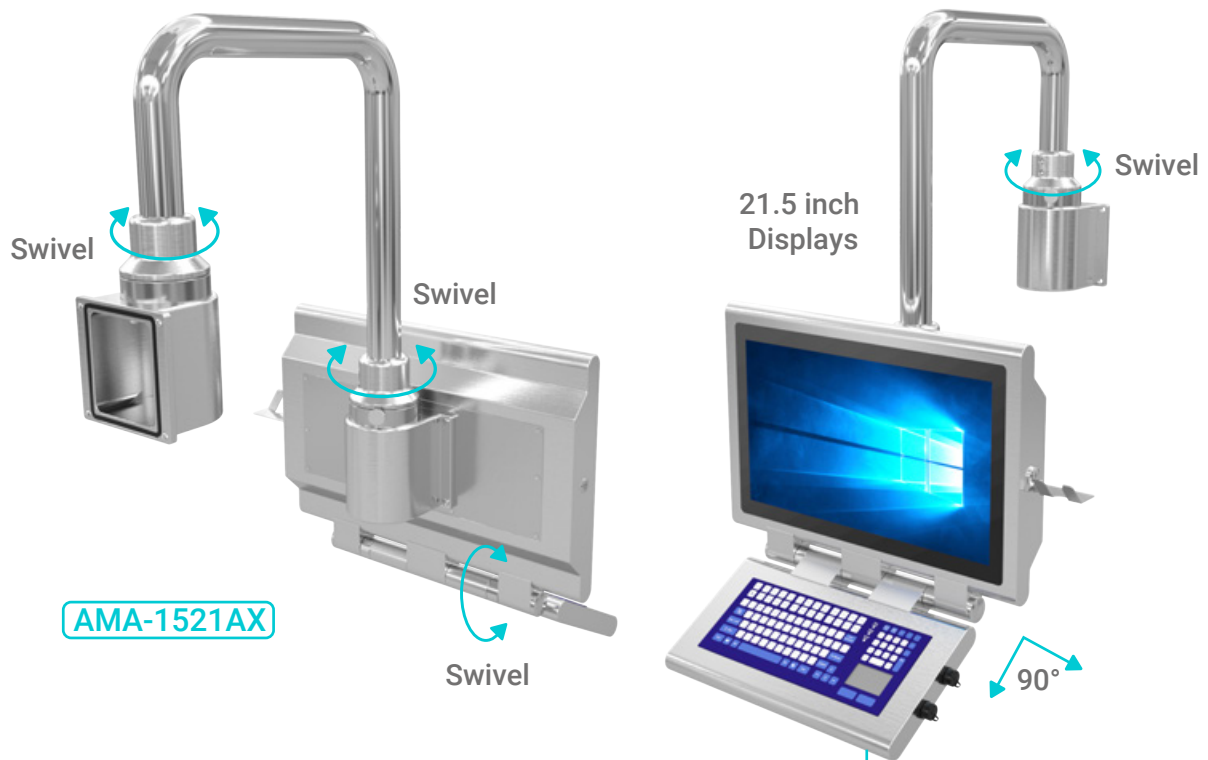

3 Keyboards Options



**A** KB-115A-AX



**B** KB-115B-AX



**C** KB-115C-AX

## AMA-1521AX Series Key Features

- 21.5" Active Matrix TFT LCD Display
- Native Resolution at 1920 x 1080
- Intel ATOM CPU/Intel 6th Gen Core-I CPU
- Up to 8GB DDR3/Up to 16GB DDR4 SO-DIMM
- Projected Capacitive Touchscreen
- NEMA 4X Stainless Steel Fully Closed Enclosure
- ThinManager Ready Version Available
- Three Waterproof Keyboard Options



NEMA 4X



IP66



Touch panel  
resistive touch



Adjustable  
angle



ThinManager  
Ready

# Accessories for AMA-1521AX

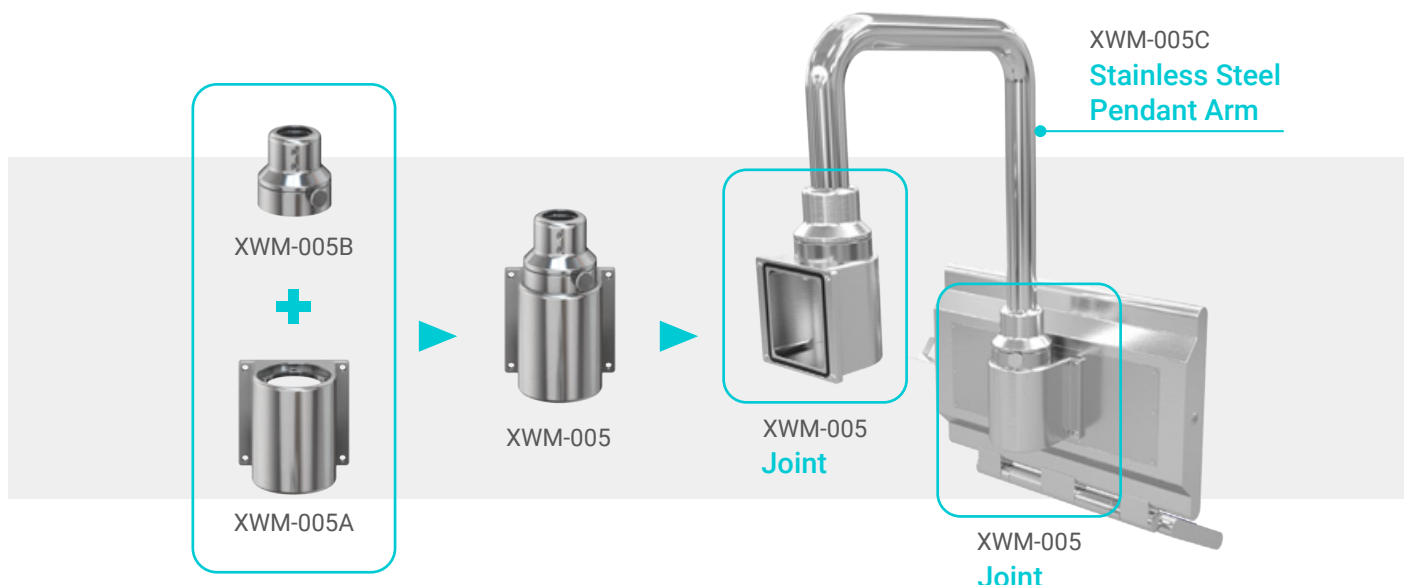

# AMA-1521AX

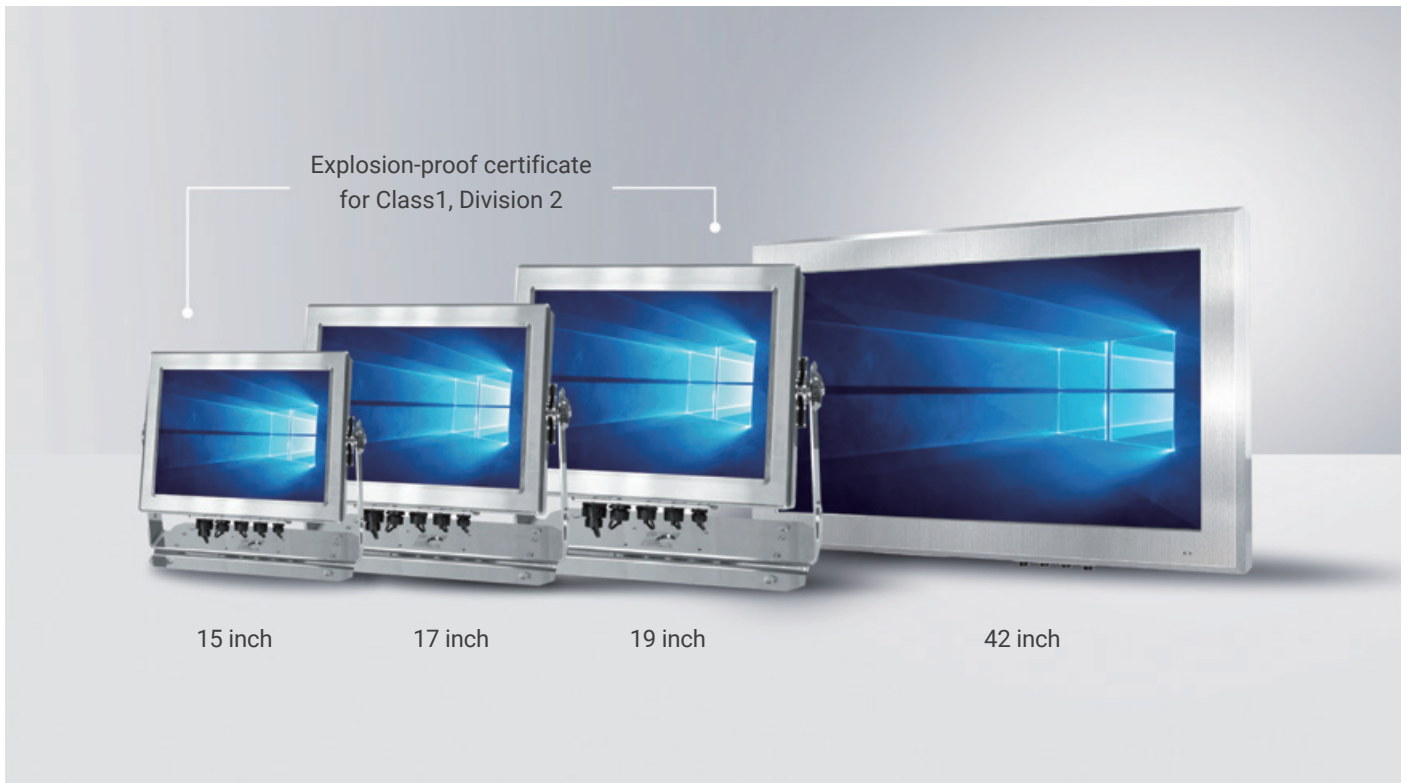

## C Waterproof Panel PC Series Class 1 Division 2 Explosion Proof Panel PC

ARISTA Class 1 Division 2 explosion-proof Panel PC series offers a variety of touch screen and LCD display size options. ARP-3821AX with Projected Capacitive touch screen and ARP-5500AX Series with 5-wire Resistive touch screen both have UL Class 1 Division 2 explosion-proof certification. Explosion-proof panel computers can prevent the explosion caused by flammable or chemical substances floating in the air, which is especially desirable in the API (Active Pharmaceutical Ingredient) stage of the pharmaceutical manufacturing process. The APR-5500AX series provides LCD display sizes in 15, 17, and 19 inches and 5-wire Resistive touch screen. ARP-3821AX provides 21.5" LCD display and Projected Capacitive touch screen.

All models have Intel Atom or Core i series CPU processor options. Arista also offers a 42-inch large format LCD display Panel PC in non-hazardous area. All ARISTA touch screen Panel PCs are integrated with NEMA 4X enclosure, which meets the IP66 waterproof requirements. The chassis is designed to avoid the equipment from being soaked or corroded by cleansers or disinfectants during the cleaning in cleanroom. Or work areas have contact with hygienical, antibacterial agents and sanitizers, such as the mild acid or alkaline: LoHse, Bleach, Lysol, LoHst, Roccal II, esphene Ilse, Spor-Klenz, etc.





## Industrial Remote Touch Display Options

ARISTA Waterproof Panel PCs and Remote Displays series are ideal for applications in cleanrooms or areas with increased sanitizing and hygiene standards. ARISTA provides LCD monitors with integrated KVM receiver and CAT 5e/6 cable solution, they are ideal for use as a remote terminal in harsh manufacturing environments or production lines. ARISTA's PoE transmitters use a single inexpensive CAT 5e/6 cable connection to enable the remote LCD monitors to display video content from the connected computer or video source. Also, ARISTA LCD monitors facilitate the concurrent delivery of uncompressed high definition video, Ethernet control, USB 2.0, and power via a CAT 5e/6 cable.

## KVM Extender for Industrial Environments

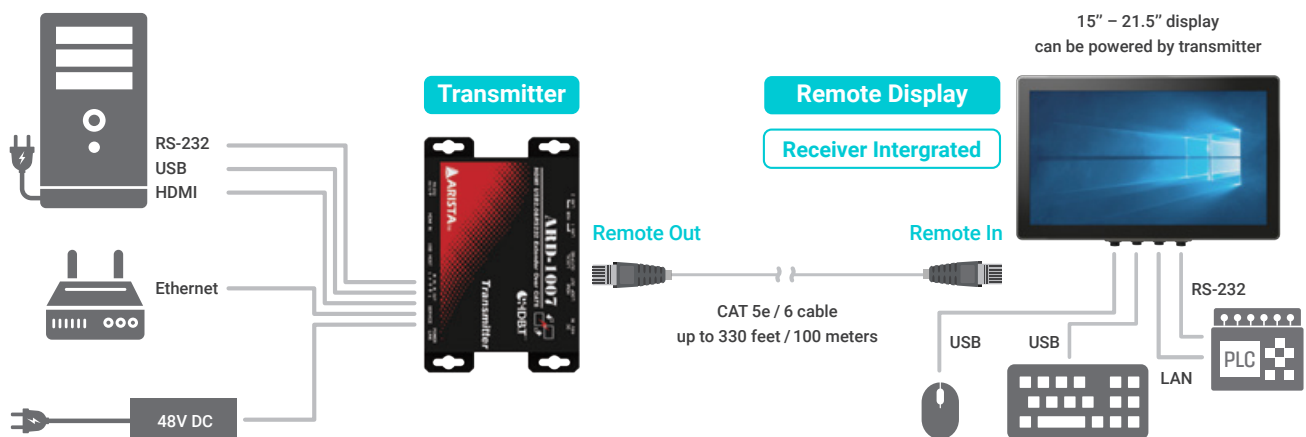



## D Waterproof Remote Display Series Extends the distance between computers and Displays / KVMs

The NEMA 4X/IP66 waterproof Remote Display and KVM (keyboard, video, mouse) series has a built-in receiver. You can transmit the HDMI, USB, and power sources via Transmitter to the Remote Display and KVM up to 330 feet (100 meters) away through a single CAT 5e/6 cable. When the signals from the computer reach the remote display through CAT 5e/6 cable, the remote display's built-in receiver decodes the signals to the connected mouse, keyboard, and touch display, while maintaining high quality display. This series is suitable for control room applications in the pharmaceutical industry and various other industries.

The 15-inch to 21.5-inch touch displays can be powered by ARISTA's transmitter that is shipped with the Remote Display and KVM. The Waterproof Remote Display Series is the ultimate solution to connect your control room and the remote display in the clearrooms; it provides a connection greater than the HDMI's 15 meters limit, keeps the picture quality clear, and requires only simple wiring. ARISTA NEMA 4X/IP66 waterproof Remote Display and KVM series are ideal for applications where displays and computers must be located in different locations with great distance.



IP66



NEMA 4X



Remote control



Touch panel resistive touch



Touch panel projected capacitive touch



Touch screen



ThinManager Ready

# Industrial Mobile Workstations



Model	AMW-1121AX-E01	AMW-1121AX-H01	AMW-1321AX-E01	AMW-1321AX-H01	AMW-1521AX-E01	AMW-1521AX-H01
Display Size	21.5 inch		21.5 inch		21.5 inch	
Resolution (Max)	1920 x 1080		1920 x 1080		1920 x 1080	
Aspect Ratio	16:9		16:9		16:9	
Response Time (Typical)	14 ms		14 ms		14 ms	
Contrast Ratio	1000:1		1000:1		1000:1	
Brightness (Max)	250 nits		250 nits		250 nits	
Touch Screen	Projected Capacitive		Projected Capacitive		Projected Capacitive	
CPU	Intel E3845 1.91GHz	Intel 2.6/3.4GHz i7-6600U	Intel E3845 1.91GHz	Intel 2.6/3.4GHz i7-6600U	Intel E3845 1.91GHz	Intel 2.6/3.4GHz i7-6600U
Chipset	Bay Trail	Skylake-U	Bay Trail	Skylake-U	Bay Trail	Skylake-U
Memory	up to 8GB DDR3 SO-DIMM	up to 16GB DDR4 SO-DIMM	up to 8GB DDR3 SO-DIMM	up to 16GB DDR4 SO-DIMM	up to 8GB DDR3 SO-DIMM	up to 16GB DDR4 SO-DIMM
Storage Option	2.5" SSD		2.5" SSD		2.5" SSD	
Keyboard/Mouse	Options: A, B, C		Options: A, B, C		Options: A, B, C	
Remote Boot	ThinManager Ready, PXE		ThinManager Ready, PXE		ThinManager Ready, PXE	
USB Port	1 x USB 2.0		1 x USB 2.0		2 x USB 2.0	
LAN/Wi-Fi	Wi-Fi		Wi-Fi		Wi-Fi	
Internal Battery	optional 1024 Ah Lithium Battery		optional 1024 Ah Lithium Battery		optional 1024 Ah Lithium Battery	
OS Support	Windows 7 & up	Windows 10	Windows 7 & up	Windows 10	Windows 7 & up	Windows 10
Power Requirement (Max)	110VAC / 6A, 220VAC / 3A		110VAC / 6A, 220VAC / 3A		110VAC / 6A, 220VAC / 3A	
Power Consumption (Max)	47 W	60 W	47 W	60 W	47 W	60 W
Recommended Power Supply	included		included		included	
Heat Dissipation	160 BTU/hr	205 BTU/hr	160 BTU/hr	205 BTU/hr	160 BTU/hr	205 BTU/hr
Dimension (WxHxD)	20.94 x 58.38 x 21.89 inch 531.8 x 1482.9 x 556.0 mm		24.09 x 57.44 x 18.19 inch 612.0 x 1459.0 x 462mm		22.52 x 54.7 x 25.77 inch 572.0 x 1389.8 x 654.4 mm	
Operating Temp	0 to 35°C (32° to 95°F)		0 to 35°C (32° to 95°F)		0 to 35°C (32° to 95°F)	
Storage Temp	-20° to 60°C (-4° to 140°F)		-20° to 60°C (-4° to 140°F)		-20° to 60°C (-4° to 140°F)	
Humidity	0% to 95%		0% to 95%		0% to 95%	
NEMA 4X	SS 316L		SS 316L		SS 316L	
Rating	meet NEMA 4X/ IP66		meet NEMA 4X/ IP66		meet NEMA 4X/ IP66	
Certification	N/A		N/A		N/A	
KVM Version	N/A		N/A		N/A	



AMW-2219AX-E01		AMW-2219AX-H01		AMW-2224AX-E01		AMW-2224AX-H01		AMW-2318AX-H01	
dual 19 inch		dual 24 inch		triple 18.5 inch					
1280 x 1024		1920 x 1080		1920 x 1080					
5:4		16:9		16:9					
5 ms		25 ms		20 ms					
1000:1		5000:1		1000:1					
350 nits		250 nits		350 nits					
Projected Capacitive		Projected Capacitive		Projected Capacitive					
Intel E3845 1.91GHz	Intel 2.6/3.4GHz i7-6600U	Intel E3845 1.91GHz	Intel 2.6/3.4GHz i7-6600U	Intel 2.6/3.4GHz i7-6600U					
Bay Trail	Skylake-U	Bay Trail	Skylake-U	Skylake-U					
up to 8GB DDR3 SO-DIMM	up to 16GB DDR4 SO-DIMM	up to 8GB DDR3 SO-DIMM	up to 16GB DDR4 SO-DIMM	up to 32GB DDR4 Memory					
2.5" SSD		2.5" SSD		2.5" SSD					
Options: A, B, C		Options: A, B, C		Options: A, B, C					
ThinManager Ready, PXE		ThinManager Ready, PXE		ThinManager Ready, PXE					
1 x USB 2.0		1 x USB 2.0		1 x USB 2.0					
Wi-Fi		Wi-Fi		Wi-Fi					
optional 1024 Ah Lithium Battery		optional 1024 Ah Lithium Battery		optional 1024 Ah Lithium Battery					
Windows 7 & up	Windows 10	Windows 7 & up	Windows 10	Windows 10					
110VAC / 6A, 220VAC / 3A		110VAC / 6A, 220VAC / 3A		110VAC / 6A, 220VAC / 3A					
48 W	61 W	71 W	84 W	96 W					
included		included		included					
164 BTU/hr	208 BTU/hr	242 BTU/hr	287 BTU/hr	328 BTU/hr					
33.82 x 62.34 x 22.06 inch 859 x 1583.4 x 560.2 mm		33.82 x 62.34 x 22.06 inch 859 x 1583.4 x 560.2 mm		33.82 x 62.34 x 22.06 inch 859 x 1583.4 x 560.2 mm					
0 to 35°C (32° to 95°F)		0 to 35°C (32° to 95°F)		0 to 35°C (32° to 95°F)					
-20° to 60°C (-4° to 140°F)		-20° to 60°C (-4° to 140°F)		-20° to 60°C (-4° to 140°F)					
0% to 95%		0% to 95%		0% to 95%					
SS 316L		SS 316L		SS 316L					
meet NEMA 4X/ IP66		meet NEMA 4X/ IP66		meet NEMA 4X/ IP66					
N/A		N/A		N/A					
N/A		N/A		N/A					

# Industrial Operator Workstations



Model	AMA-1521AX-E01	AMA-1521AX-H01	AMA-1521AX-KVM	AMA-2521AX-E01	AMA-2521AX-H01
Display Size	21.5 inch			dual 21.5 inch	
Resolution (Max)	1920 x 1080			1920 x 1080	
Aspect Ratio	16:9			16:9	
Response Time (Typical)	14 ms			14 ms	
Contrast Ratio	1000:1			1000:1	
Brightness (Max)	250 nits			250 nits	
Touch Screen	Projected Capacitive			Projected Capacitive	
Video	N/A		HDMI via Transmitter	N/A	
Touch Interface	N/A		via Transmitter	N/A	
CPU	Intel E3845 1.91GHz	Intel 2.6/3.4GHz i7-6600U	N/A	Intel E3845 1.91GHz	Intel 2.6/3.4GHz i7-6600U
Chipset	Bay Trail	Skylake-U	N/A	Bay Trail	by CPU
Memory	up to 8GB DDR3 SO-DIMM	up to 16GB DDR4 SO-DIMM	N/A	up to 8GB DDR3 SO-DIMM	up to 16GB DDR4 SO-DIMM
Storage Option	2.5" SSD		N/A	2.5" SSD	
Keyboard/Mouse	options: A, B, C			options: A, B, C	
Remote Boot	ThinManager Ready, PXE		N/A	ThinManager Ready, PXE	
USB Port	2 x USB 2.0			2 x USB 2.0	
LAN/Wi-Fi	1 x Gigabit		N/A	1 x Gigabit	
OS Support	up to Windows 10			up to Windows 10	
Power Requirement (Max)	24VDC / 3A, 24VDC / 4A		powered by Transmitter	24VDC / 4A, 24VDC / 5A	
Power Consumption (Max)	47W	60 W	21 W	65 W	78 W
Recommended Power Supply	68 W	86 W	29 W	93 W	112 W
Heat Dissipation	160 BTU/hr	205 BTU/hr	70 BTU/hr	222 BTU/hr	383 BTU/hr
Mounting	Wall mount			Wall mount	
Net Weight	-			-	
Dimension (WxHxD)	22.52 x 54.7 x 25.77 inch 572.0 x 1389.8 x 654.4 mm			26.12 x 46.17 x 23.98 inch 663.5 x 1172.64 x 609 mm	
Recommended Cutout Dimension (WxH)	N/A			N/A	
Operating Temp	0 to 50°C (32° to 122°F)			0 to 50°C (32° to 122°F)	
Storage Temp	-20° to 60°C (-4° to 140°F)			-20° to 60°C (-4° to 140°F)	
Humidity	0% to 95%			0% to 95%	
NEMA 4X	SS 316L			SS 316L	
Rating	meet NEMA 4X/ IP66			meet NEMA 4X/ IP66	
Certification	N/A			N/A	





AMA-3821AX-E01	AMA-3821AX-H01	AMA-2121AX-KVM	AMA-5500AX-E01	AMA-5500AX-H01	AMA-5800AX-KVM
21.5 inch			15~19 inch		
1920 x 1080			up to 1280 x 1024		
16:9			4:3 / 5:4		
14 ms			8~30 ms		
1000:1			Up to 1000:1		
250 nits			300~350 nits		
Projected Capacitive			5-wire Resistive		
N/A		HDMI via Transmitter	N/A		HDMI via Transmitter
N/A		via Transmitter	N/A		via Transmitter
Intel E3845 1.91GHz	Intel 2.6/3.4GHz i7-6600U	N/A	Intel E3845 1.91GHz	Intel 2.6/3.4GHz i7-6600U	N/A
Bay Trail	by CPU	N/A	Bay Trail	by CPU	N/A
up to 8GB DDR3 SO-DIMM	up to 16GB DDR4 SO-DIMM	N/A	up to 8GB DDR3 SO-DIMM	up to 16GB DDR4 SO-DIMM	N/A
2.5" SSD		N/A	2.5" SSD		N/A
options: A, B, C			options: A, B, C		
ThinManager Ready, PXE		N/A	ThinManager Ready, PXE		N/A
1 x USB 2.0		2 x USB 2.0	1 x USB 2.0		2 x USB 2.0
1 x Gigabit		N/A	1 x Gigabit		
up to Windows 10			up to Windows 10		
24VDC / 3A, 24VDC / 4A		powered by Transmitter	24VDC / 3A, 24VDC / 4A		powered by Transmitter
47 W	60 W	21 W	28-47 W	41-60 W	11-21 W
68 W	86 W	29 W	40-68 W	59-86 W	15-29 W
160 BTU/hr	205 BTU/hr	70 BTU/hr	96-160 BTU/hr	140-205 BTU/hr	36-70 BTU/hr
Wall mount			Wall mount		
-			27-32 Lbs / 12.24-14.51 Kg		
37.57 x 20.78 x 10.49 inch 532 x 954.4 x 266.53 mm			Up to 17.8 x 15.19 x 4.4 inch Up to 452.1 x 385.8 x 111.8 mm		
N/A			N/A		
0 to 50°C (32° to 122°F)			0 to 50°C (32° to 122°F)		
-20° to 60°C (-4° to 140°F)			-20°C to 60°C (-4°F to 140°F)		
0% to 95%			0% to 95%		
SS 316L			SS 316L		
meet NEMA 4X/ IP66			meet NEMA 4X/ IP66		
available			N/A		

# Industrial Operator Workstations



Model	AMA-7015AX-E01	AMA-7015AX-H01	AMA-7019AX-E01	AMA-7019AX-H01
Display Size	15 inch		19 inch	
Resolution (Max)	1024 x 768		1028 x 1024	
Aspect Ratio	4:3		5:4	
Response Time (Typical)	8 ms		5 ms	
Contrast Ratio	700:1		1000:1	
Brightness (Max)	300 nits		350 nits	
Touch Screen	5-wire Resistive		5-wire Resistive	
CPU	Intel E3845 1.91GHz	Intel 2.6/3.4GHz i7-6600U	Intel E3845 1.91GHz	Intel 2.6/3.4GHz i7-6600U
Chipset	Bay Trail	by CPU	Bay Trail	by CPU
Memory	up to 8GB DDR3 SO-DIMM	up to 16GB DDR4 SO-DIMM	up to 8GB DDR3 SO-DIMM	up to 16GB DDR4 SO-DIMM
Storage Option	2.5" SSD		2.5" SSD	
Keyboard/Mouse	Options: A, B, C		Options: A, B, C	
Remote Boot	ThinManager Ready, PXE		ThinManager Ready, PXE	
USB Port	N/A		N/A	
LAN/WiFi	1 x Gigabit		1 x Gigabit	
OS Support	Windows 7 & up	Windows 10	Windows 7 & up	Windows 10
Power Requirement (Max)	110VAC / 1.5A, 220VAC / 1A		110VAC / 1.5A, 220VAC / 1A	
Power Consumption (Max)	28 W	41 W	47 W	60 W
Recommended Power Supply	included		included	
Heat Dissipation	96 BTU/hr	140 BTU/hr	160 BTU/hr	205 BTU/hr
Mounting	Wall-recessed		Wall-recessed	
Dimension (WxHxD)	26.39 x 32.61 x 7.44 inch 670.2 x 828.2 x 188.9 mm		26.39 x 33.61 x 7.44 inch 670.2 x 828.2 x 188.9 mm	
Recommended Cutout Dimension (WxH)	26.39 x 32.61 inch 670.2 x 828.2 mm		26.39 x 32.61 inch 670.2 x 828.2 mm	
Operating Temp	0 to 50°C (32° to 122°F)		0 to 50°C (32° to 122°F)	
Storage Temp	-20°C to 60°C (-4°F to 140°F)		-20° to 60°C (-4° to 140°F)	
Humidity	5% to 95% (non-condensing)	0% to 95%	0%-95%	
NEMA 4X	SS 316L		SS 316L	
Rating	meet NEMA 4X/ IP66		meet NEMA 4X/ IP66	
Certification	N/A		N/A	



AMA-7021AX-E01		AMA-7021AX-H01		AMA-7155AX-E01		AMA-7155AX-H01	
21.5 inch		21.5 inch		55 inch		55 inch	
1920 x 1080		1920 x 1080		1920 x 1080		1920 x 1080	
16:9		16:9		16:9		16:9	
14 ms		14 ms		6.5 ms		6.5 ms	
1000:1		1000:1		4000:1		4000:1	
250 nits		250 nits		500 nits		500 nits	
5-wire Resistive		5-wire Resistive		Projected Capacitive		Projected Capacitive	
Intel E3845 1.91GHz	Intel 2.6/3.4GHz i7-6600U	Intel E3845 1.91GHz	Intel 2.6/3.4GHz i7-6600U	Intel E3845 1.91GHz	Intel 2.6/3.4GHz i7-6600U	Intel E3845 1.91GHz	Intel 2.6/3.4GHz i7-6600U
Bay Trail	by CPU	Bay Trail	by CPU	Bay Trail	by CPU	Bay Trail	by CPU
up to 8GB DDR3 SO-DIMM	up to 16GB DDR4 SO-DIMM	up to 8GB DDR3 SO-DIMM	up to 16GB DDR4 SO-DIMM	up to 8GB DDR3 SO-DIMM	up to 16GB DDR4 SO-DIMM	up to 8GB DDR3 SO-DIMM	up to 16GB DDR4 SO-DIMM
2.5" SSD		2.5" SSD		2.5" SSD		2.5" SSD	
Options: A, B, C		Options: A, B, C		Options: A, B, C		Options: A, B, C	
ThinManager Ready, PXE		ThinManager Ready, PXE		ThinManager Ready, PXE		ThinManager Ready, PXE	
N/A		N/A		N/A		N/A	
1 x Gigabit		1 x Gigabit		1 x Gigabit		1 x Gigabit	
Windows 10		Windows 10		Windows 10		Windows 10	
110VAC / 1.5A, 220VAC / 1A		110VAC / 1.5A, 220VAC / 1A		110VAC / 1.5A, 220VAC / 1A		110VAC / 1.5A, 220VAC / 1A	
47 W	60 W	139 W	152 W	139 W	152 W	139 W	152 W
68 W	86 W	included		included		included	
160 BTU/hr	205 BTU/hr	475 BTU/hr	519 BTU/hr	475 BTU/hr	519 BTU/hr	475 BTU/hr	519 BTU/hr
Wall-recessed		Wall-recessed		Wall-recessed		Wall-recessed	
29.71 x 32.68 x 7.42 inch 754.6 x 830 x 188.4 mm		29.71 x 32.68 x 7.42 inch 754.6 x 830 x 188.4 mm		62.15 x 41.32 inch 1578.6 x 1049.6 mm		62.15 x 41.32 inch 1578.6 x 1049.6 mm	
29.71 x 32.68 inch 754.6 x 830 mm		29.71 x 32.68 inch 754.6 x 830 mm		62.15 x 41.32 inch 1578.6 x 1049.6 mm		62.15 x 41.32 inch 1578.6 x 1049.6 mm	
0 to 50°C (32° to 122°F)		0 to 50°C (32° to 122°F)		0 to 50°C (32° to 122°F)		0 to 50°C (32° to 122°F)	
-20° to 60°C (-4° to 140°F)		-20° to 60°C (-4° to 140°F)		-20° to 60°C (-4° to 140°F)		-20° to 60°C (-4° to 140°F)	
5% to 95% (non-condensing)		5% to 95% (non-condensing)		5% to 95% (non-condensing)		5% to 95% (non-condensing)	
SS 316L		SS 316L		SS 316L		SS 316L	
meet NEMA 4X/ IP66		meet NEMA 4X/ IP66		meet NEMA 4X/ IP66		meet NEMA 4X/ IP66	
N/A		N/A		N/A		N/A	

# Industrial Operator Workstations



Model	AMA-7421AX-E01	AMA-7421AX-H01	AMA-7421AX-KVM
Display Size	21.5 inch		
Resolution (Max)	1280 x 1024		
Aspect Ratio	16:9		
Response Time (Typical)	14 ms		
Contrast Ratio	1000:1		
Brightness (Max)	250 nits		
Touch Screen	Projected Capacitive		
Video	N/A		HDMI via Transmitter
Touch Interface	N/A		via Transmitter
CPU	Intel E3845 1.91GHz	Intel 2.6/3.4GHz i7-6600U	N/A
Chipset	Bay Trail	by CPU	N/A
Memory	up to 8GB DDR3 SO-DIMM	up to 16GB DDR4 SO-DIMM	N/A
Storage Option	2.5" SSD		N/A
Keyboard/Mouse	options: A, B, C		
Remote Boot	ThinManager Ready, PXE		N/A
USB Port	1 x USB 2.0		
LAN/WiFi	1 x Gigabit		N/A
OS Support	Windows 10		
Power Requirement (Max)	110VAC / 1.5A, 220VAC / 1A		powered by Transmitter
Power Consumption (Max)	47 W	60 W	N/A
Recommended Power Supply	68 W	86 W	N/A
Heat Dissipation	160 BTU/hr	205 BTU/hr	N/A
Mounting	Pedestal		
Dimension (WxHxD)	24.57 x 59.69 x 13.58 inch 624 x 1516.3 x 344.89 mm		
Recommended Cutout Dimension (WxH)	N/A		
Operating Temp	0 to 50°C (32° to 122°F)		
Storage Temp	-20° to 60°C (-4° to 140°F)		
Humidity	5% to 95% non-condensing		
NEMA 4X	SS 316L		
Rating	meet NEMA 4X/ IP66		
Certification	N/A		



AMA-8121AX-E01		AMA-8121AX-H01		AMA-8121AX-KVM	AMA-8221AX-E01		AMA-8221AX-H01	
		21.5 inch			dual 21.5 inch			
		1920 x 1080			1920 x 1080			
		16:9			16:9			
		14 ms			14 ms			
		1000:1			1000:1			
		250 nits			250 nits			
		Projected Capacitive			Projected Capacitive			
		N/A		HDMI via Transmitter	N/A			
		N/A		via Transmitter	N/A			
		Intel 2.6/3.4GHz i7-6600U		N/A	Intel E3845 1.91GHz	Intel 2.6/3.4GHz i7-6600U		
		Bay Trail	by CPU	N/A	Bay Trail	by CPU		
up to 8GB DDR3 SO-DIMM	up to 16GB DDR4 SO-DIMM			N/A	up to 8GB DDR3 SO-DIMM	up to 16GB DDR4 SO-DIMM		
		2.5" SSD		N/A	2.5" SSD			
		options: A, B, C			options: A, B, C			
		ThinManager Ready, PXE		N/A	ThinManager Ready, PXE			
		2 x USB 2.0			2 x USB 2.0			
		1 x Gigabit		N/A	1 x Gigabit			
		Windows 10			Windows 10			
		24VDC / 3A, 24V DC / 4A		powered by Transmitter	24VDC / 4A, 24V DC / 5A			
47 W	60 W			N/A	65 W	78 W		
68 W	86 W			N/A	93 W	112 W		
160 BTU/hr	205 BTU/hr			N/A	222 BTU/hr	383 BTU/hr		
		Pedestal			Pedestal			
		25.98 x 62.41 x 20.12 inch 660 x 1585.01 x 511 mm			52.13 x 62.41 x 19.72 inch 1324 x 1585 x 501 mm			
		N/A			N/A			
		0 to 50°C (32° to 122°F)			0 to 50°C (32° to 122°F)			
		-20° to 60°C (-4° to 140°F)			-20° to 60°C (-4° to 140°F)			
		5% to 95% non-condensing			5% to 95% non-condensing			
		SS 316L			SS 316L			
		meet NEMA 4X/ IP66			meet NEMA 4X/ IP66			
		N/A			N/A			

# Industrial Operator Workstations



Model	ARP-3821AX-E01	ARP-3821AX-H01	ARP-5515AX-E01	ARP-5515AX-H01
Display Size	21.5 inch		15 inch	
Resolution (Max)	1920 x 1080		1024 x 768	
Aspect Ratio	16:9		4:3	
Response Time (Typical)	14 ms		8 ms	
Contrast Ratio	1000:1		700:1	
Brightness (Max)	250 nits		300 nits	
Touch Screen	Projected Capacitive		5-wire Resistive	
CPU	Intel E3845 1.91GHz	Intel 2.6/3.4 GHz i7-6600U	Intel E3845 1.91GHz	Intel 2.6/3.4 GHz i7-6600U
Chipset	Bay Trail	by CPU	Bay Trail	by CPU
Memory	up to 8GB DDR3 SO-DIMM	up to 16GB DDR4 SO-DIMM	up to 8GB DDR3 SO-DIMM	up to 16GB DDR4 SO-DIMM
Video Controller	Intel Gen7 Graphics DX 11, OGL3.2	Intel HD Graphics 520	Intel Gen7 Graphics DX 11, OGL3.2	Intel HD Graphics 520
Storage Option	2.5" SSD		2.5" SSD	
Keyboard/Mouse	USB		USB	
Remote Boot	ThinManager Ready, PXE		ThinManager Ready, PXE	
USB Port	2 x USB 2.0		2 x USB 2.0	
LAN/Wi-Fi	1 x Gigabit		1 x Gigabit	
OS Support	Windows 7 & up	Windows 10	Windows 7 & up	Windows 10
Power Requirement (Max)	24VDC / 1.58A	24VDC / 2.50A	24VDC / 1.17A	24VDC / 1.71A
Power Consumption (Max)	47 W	60 W	28 W	41 W
Recommended Power Supply	68 W	86 W	40 W	59 W
Heat Dissipation	160 BTU/hr	250 BTU/hr	96 BTU/hr	140 BTU/hr
Mounting	Pedestal/VESA/Wall/Ceiling/Benchtop		Pedestal/VESA/Wall/Ceiling/Benchtop	
Net Weight	27 Lbs / 12.25 Kg		32 Lbs/ 14.52 kg	
Dimension (WxHxD)	20.94 x 13.64 x 3.69 inch 532 x 346.4 x 93.7 mm		14.51 x 12.42 x 4.09 inch 368.6 x 315.5 x 103.9 mm	
Operating Temp	0 to 50°C (32° to 122°F)		0 to 50°C (32° to 122°F)	
Storage Temp	-20° to 60°C (-4° to 140°F)		-20° to 60°C (-4° to 140°F)	
Humidity	0% to 95%		0% to 95%	
NEMA 4X	SS 316L		SS 304/SS 316L	
Rating	meet NEMA 4X/ IP66		meet NEMA 4X/ IP66	
Certification	UL C1D2		UL C1D2	



ARP-5517AX-E01		ARP-5517AX-H01		ARP-5519AX-E01		ARP-5519AX-H01		ARP-5542AX-E01			
17 inch		17 inch		19 inch		19 inch		42 inch			
1280 x 1024		1280 x 1024		1280 x 1024		1280 x 1024		1920 x 1080			
5:4		5:4		5:4		5:4		16:9			
30 ms		30 ms		5 ms		5 ms		8 ms			
800:1		800:1		1000:1		1000:1		4000:1			
350 nits		350 nits		350 nits		350 nits		500 nits			
5-wire Resistive				5-wire Resistive				Infrared			
Intel E3845 1.91GHz		Intel 2.6/3.4 GHz i7-6600U		Intel E3845 1.91GHz		Intel 2.6/3.4 GHz i7-6600U		Intel E3845 1.91GHz			
Bay Trail		by CPU		Bay Trail		by CPU		Bay Trail			
up to 8GB DDR3 SO-DIMM		up to 16GB DDR4 SO-DIMM		up to 8GB DDR3 SO-DIMM		up to 16GB DDR4 SO-DIMM		up to 8GB DDR3 SO-DIMM			
Intel Gen7 Graphics DX 11, OGL3.2		Intel HD Graphics 520		Intel Gen7 Graphics DX 11, OGL3.2		Intel HD Graphics 520		Intel Gen7 Graphics DX 11, OGL3.2			
2.5" SSD		2.5" SSD		2.5" SSD		2.5" SSD		2.5" SSD			
USB		USB		USB		USB		USB			
ThinManager Ready, PXE		ThinManager Ready, PXE		ThinManager Ready, PXE		ThinManager Ready, PXE		ThinManager Ready, PXE			
2 x USB 2.0		2 x USB 2.0		2 x USB 2.0		2 x USB 2.0		2 x USB 2.0			
1 x Gigabit		1 x Gigabit		1 x Gigabit		1 x Gigabit		2 x Gigabit			
Windows 7 & up		Windows 10		Windows 7 & up		Windows 10		Windows 7 & up			
24VDC / 1.25A		24VDC / 2A		24VDC / 1.25A		24VDC / 2.50A		24VDC / 7.54A			
35 W		48 W		47 W		60 W		181 W			
50 W		69 W		68 W		86 W		259 W			
120 BTU/hr		164 BTU/hr		161 BTU/hr		205 BTU/hr		618 BTU/hr			
Pedestal/VESA/Wall/Ceiling/Benchtop				Pedestal/VESA/Wall/Ceiling/Benchtop				Wall mount			
34 Lbs / 15.42 Kg		34 Lbs / 15.42 Kg		35 Lbs / 15.88 Kg		35 Lbs / 15.88 Kg		110 Lbs/ 50 kg			
15.88 x 14.07 x 4.36 inch 403.4 x 357.4 x 110.7 mm		15.88 x 14.07 x 4.36 inch 403.4 x 357.4 x 110.7 mm		17.8 x 15.19 x 4.4 inch 452.1 x 385.8 x 111.8 mm		17.8 x 15.19 x 4.4 inch 452.1 x 385.8 x 111.8 mm		42.87 x 27.29 x 5.38 inch 1089x 693.05 x 136.1 mm			
0 to 50°C (32° to 122°F)		0 to 50°C (32° to 122°F)		0 to 50°C (32° to 122°F)		0 to 50°C (32° to 122°F)		0 to 50°C (32° to 122°F)			
-20° to 60°C (-4° to 140°F)		-20° to 60°C (-4° to 140°F)		-20° to 60°C (-4° to 140°F)		-20° to 60°C (-4° to 140°F)		-20° to 60°C (-4° to 140°F)			
0% to 95%		0% to 95%		0% to 95%		0% to 95%		0% to 95%			
SS 304/SS 316L		SS 304/SS 316L		SS 304/SS 316L		SS 304/SS 316L		SS 304/SS 316L			
meet NEMA 4X/ IP66		meet NEMA 4X/ IP66		meet NEMA 4X/ IP66		meet NEMA 4X/ IP66		meet NEMA 4X/ IP66			
UL C1D2		UL C1D2		UL C1D2		UL C1D2		N/A			

# Industrial KVM Extender Integrated Displays



Model Name	ADM-2121AX-00A	ADM-5815AX-00A
Display Size	21.5 inch	15 inch
Resolution (Max)	1920 x 1080	1024 x 768
Aspect Ratio	16:9	4:3
Response time (Typical)	14 ms	8 ms
Contrast Ratio	1000:1	700:1
Brightness (Max)	250 nits	300 nits
Video Input	HDMI via Transmitter	HDMI via Transmitter
Touch Screen	Projected Capacitive	5-wire Resistive
USB	2 x USB 2.0	2 x USB 2.0
Touch Interface	via Transmitter	via Transmitter
OS Support	Windows XP, Windows 7 & up	Windows XP, Windows 7 & up
Power Requirement (Max)	powered by Transmitter	powered by Transmitter
Power Consumption (Max)	21 W	11 W
Recommended Power Supply	29 W	15 W
Heat Dissipation	70 BTU/hr	36 BTU/hr
Mounting	Pedestal/VESA/Wall/Ceiling/Benchtop	Pedestal/VESA/Wall/Ceiling/Benchtop
Net Weight	20 Lbs/ 9.07 kg	27 Lbs/ 12.24 kg
Dimension (WxHxD)	22.89 x 13.74 x 1.93 inch 581.4 x 348.9 x 49.1 mm	14.51 x 12.42 x 4.09 inch 368.6 x 315.5 x 103.9 mm
Operating Temp	0~50°C (32~122°F)	0 to 50°C (32 to 122°F)
Storage Temp	-20~60°C (-4~140°F)	-20 to 60°C (-4 to 140°F)
Humidity	5% to 95% non-condensing	5% to 95% non-condensing
Nema 4X	SS 304/316L	SS 304/316L
Rating	meet NEMA 4X/ IP66	meet NEMA 4X/ IP66
Certification	N/A	N/A





ADM-5817AX-00 A	ADM-5819AX-00A	ADM-5842AX-00A
17 inch	19 inch	42 inch
1280 x 1024	1280 x 1024	1920 x 1080
5:4	5:4	16:9
30 ms	5 ms	8 ms
800:1	1000:1	4000:1
350 nits	350 nits	500 nits
HDMI via Transmitter	HDMI via Transmitter	HDMI via Transmitter
5-wire Resistive	5-wire Resistive	Infrared
2 x USB 2.0	2 x USB 2.0	2 x USB 2.0
via Transmitter	via Transmitter	via Transmitter
Windows XP, Windows 7 & up	Windows XP, Windows 7 & up	Windows XP, Windows 7 & up
powered by Transmitter	powered by Transmitter	24VDC/6.83A
21 W	21 W	164 W
29 W	29 W	234 W
70 BTU/hr	70 BTU/hr	559 BTU/hr
Pedestal/VESA/Wall/Ceiling/Benchttop	Pedestal/VESA/Wall/Ceiling/Benchttop	VESA mount/Wall mount
29 Lbs / 13.15 Kg	32 Lbs / 14.51 Kg	110 Lbs/ 50 kg
15.88 x 14.07 x 4.36 inch 403.4 x 357.4 x 110.7 mm	17.80 x 15.19 x 4.40 inch 452.1 x 385.8 x 111.8 mm	42.87 x 27.29 x 5.38 inch 1089.0 x 693.05 x 136.1 mm
0 to 50°C (32 to 122°F)	0 to 50°C (32 to 122°F)	0 to 50°C (32 to 122°F)
-20 to 60°C (-4 to 140°F)	-20 to 60°C (-4 to 140°F)	-20 to 60°C (-4 to 140°F)
5% to 95% non-condensing	5% to 95% non-condensing	0% to 95% non-condensing
SS 304/316L	SS 304/316L	SS 304/316L
meet NEMA 4X/ IP66	meet NEMA 4X/ IP66	meet NEMA 4X/ IP66
N/A	N/A	N/A

